

Director

For ORIENT BUILDERS & DEVELOPER
(A Unit of Swan Industries Ltd.)

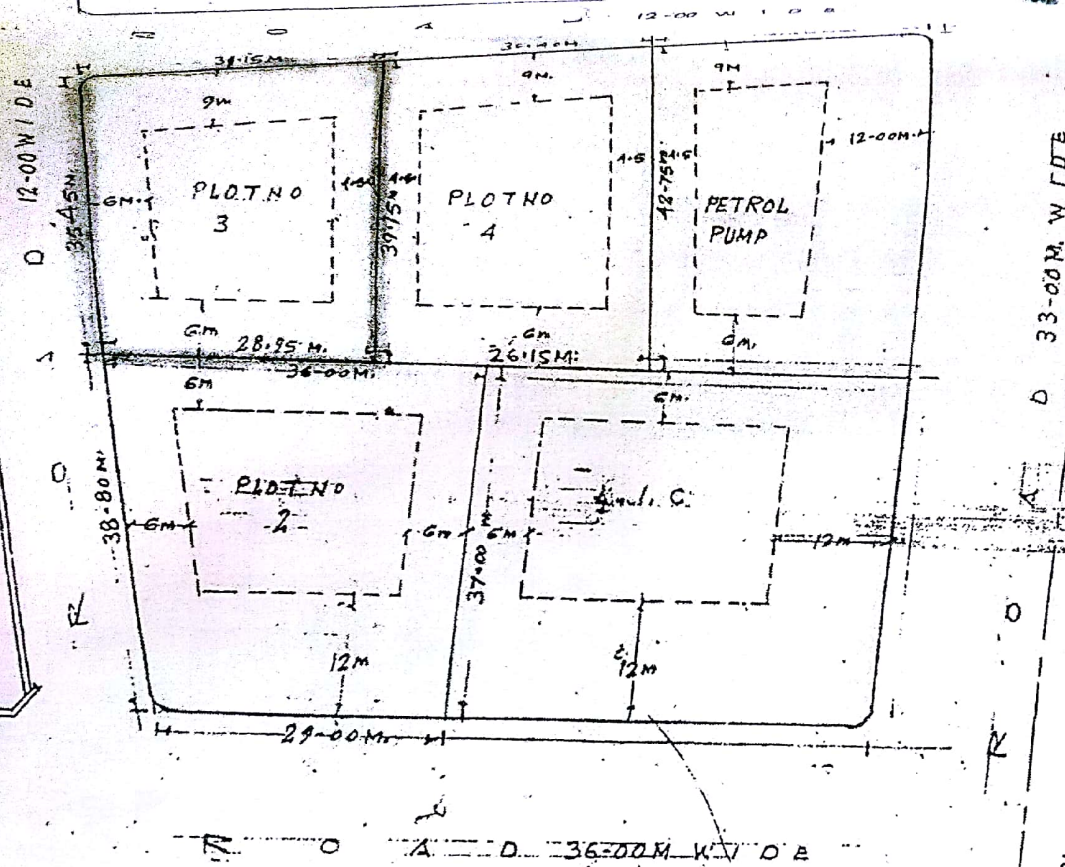

TO RESIDUAL

TO RANGHARI

AREA OF PLOT NO. 3. $28.95 \times 12.00 = 347.4$
 AREA OF PLOT NO. 4. $20.15 \times 12.00 = 241.8$
 AREA OF PLOT NO. 2. $28.95 \times 12.00 = 347.4$
 AREA OF PLOT NO. 1. $20.15 \times 12.00 = 241.8$

NOTE:

SITE PLAN PREPARED AS PER M.
 GIVEN BY J.E.N. SH.
 ON AUCTION NOTE SHEET DATED

PARAMETERS:-

SET BACKS - AS SHOWN
 F.A.R. - 1.75
 MAX. PERA. HEIGHT - 24
 PER. GR COVERAGE - 35

SITE PLAN OF PLOT NO.
 BALAJI MARKET SCHEME K

SURVED BY	U.T. DRG
	SCALE 1:10
DRAWN BY 16-3-05	ASST. TOWN
	U.I. T.K.
CHECKED BY	DEPUTY TOWN

