

RIDDHI MENSION ,  
KUNHADI

PROPOSED LAYOUT PLAN FOR  
RESIDENTIAL PLOT'S SCHEME  
NEAR EXOTICA GARDEN BUNDI  
ROAD IN KHASRA NO.:-76(PART)  
VILLAGE :KUNARI  
TEH. LADPURA,DIST. KOTA (RAJ.)

PROPOSED SECTOR ROAD - 60 FT.

PROPOSED SECTOR ROAD - 60 FT.

PROPOSED SECTOR  
ROAD - 60 FT. TO BUNDI ROAD

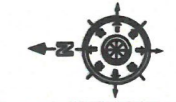
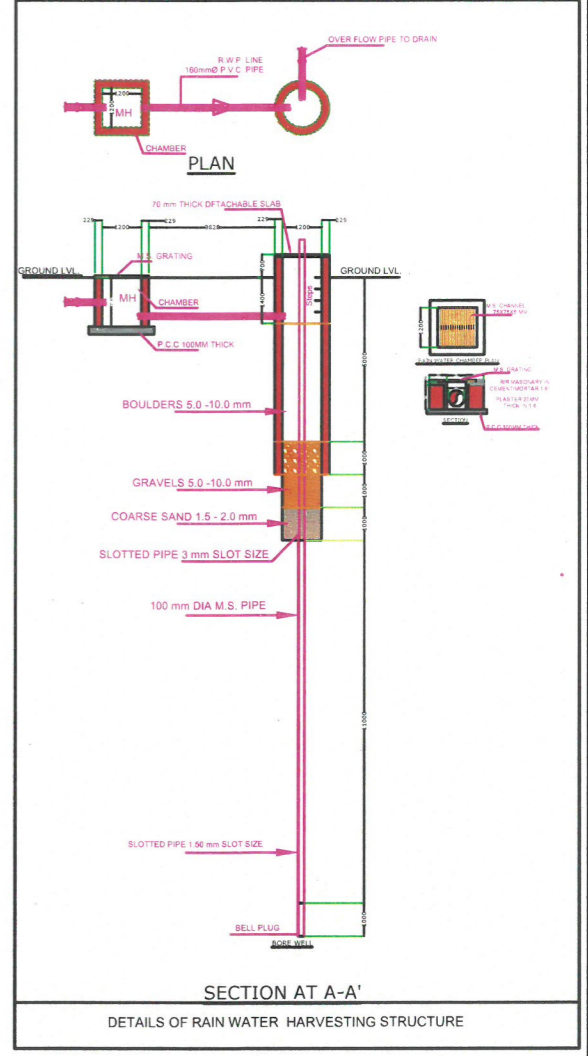
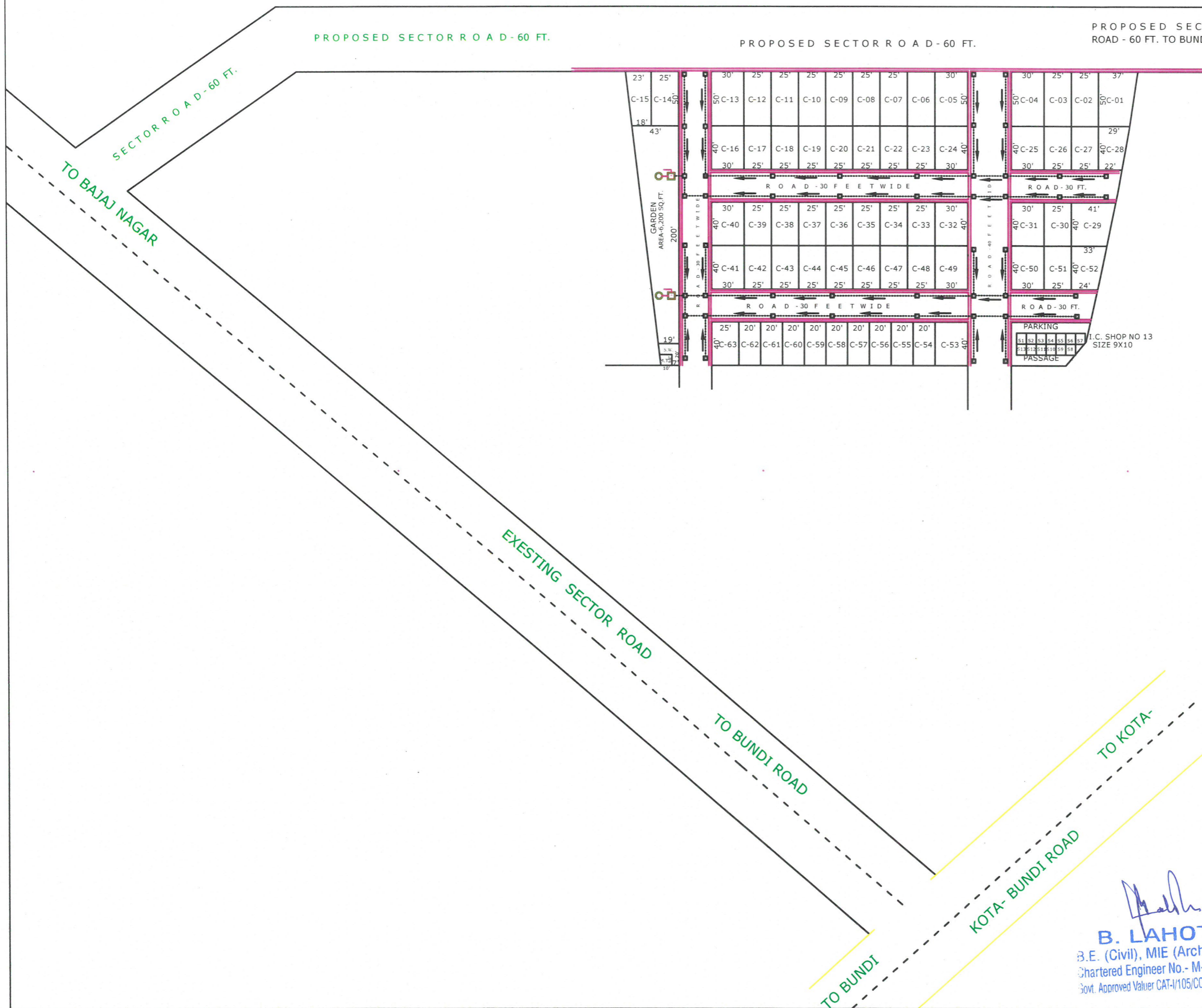

*B. Lahoty*  
**B. LAHOTY**  
B.E. (Civil), MIE (Arch. Engg)  
Chartered Engineer No. - M-119028  
Govt. Approved Valuer CAT-1/105/CCIT/T-63/96

|                |   |
|----------------|---|
| Client         |   |
| Project        | PROPOSED LAYOUT PLAN FOR<br>RESIDENTIAL PLOT'S SCHEME<br>NEAR EXOTICA GARDEN BUNDI<br>ROAD IN KHASRA NO.:-76(PART)<br>VILLAGE :KUNARI<br>TEH. LADPURA,DIST. KOTA (RAJ.) |
| Drawing Title  | RAIN WATER HARVESTING PLAN  |
| SCALE : 1"=40' | NAME OF SCHEME:   |
| LOCATION :     | DRAWING NO. -   |
| JOB NO. -      | DATE - APR., 27th, 2024   |

RAIN WATER HARVESTING PLAN