

# REVISED SITE PLAN OF GROUP HOUSING PLOT

IN KHASRA NO.- 129,130,131,132,133,134,135,136,137,141,142,142/239,282/138  
AT REVENUE VILLAGE- CHIMANPURA, TEH.-SANGANER, JAIPUR.

## AREA ANALYSIS :-

TOTAL GROUP HOUSING PLOT	= 59919.89 SQ. YDS.
AREA UNDER PROPOSED 24 MT. WIDE ROAD	= 1271.64 SQ. YDS.
AREA UNDER EXISTING 12 MT. WIDE ROAD	= 843.78 SQ. YDS.
5% JDA FACILITY AREA	= 2890.25 SQ. YDS.
NET PLOT AREA OF GROUP HOUSING PLOT	= 54914.88 SQ. YDS.
F.A.R	= 1.33 (STANDARD)
GROUND COVERAGE	= 35%
HEIGHT :-	= AS PER BUILDING BYE LAWS

SCALE: 1" : 200'00"

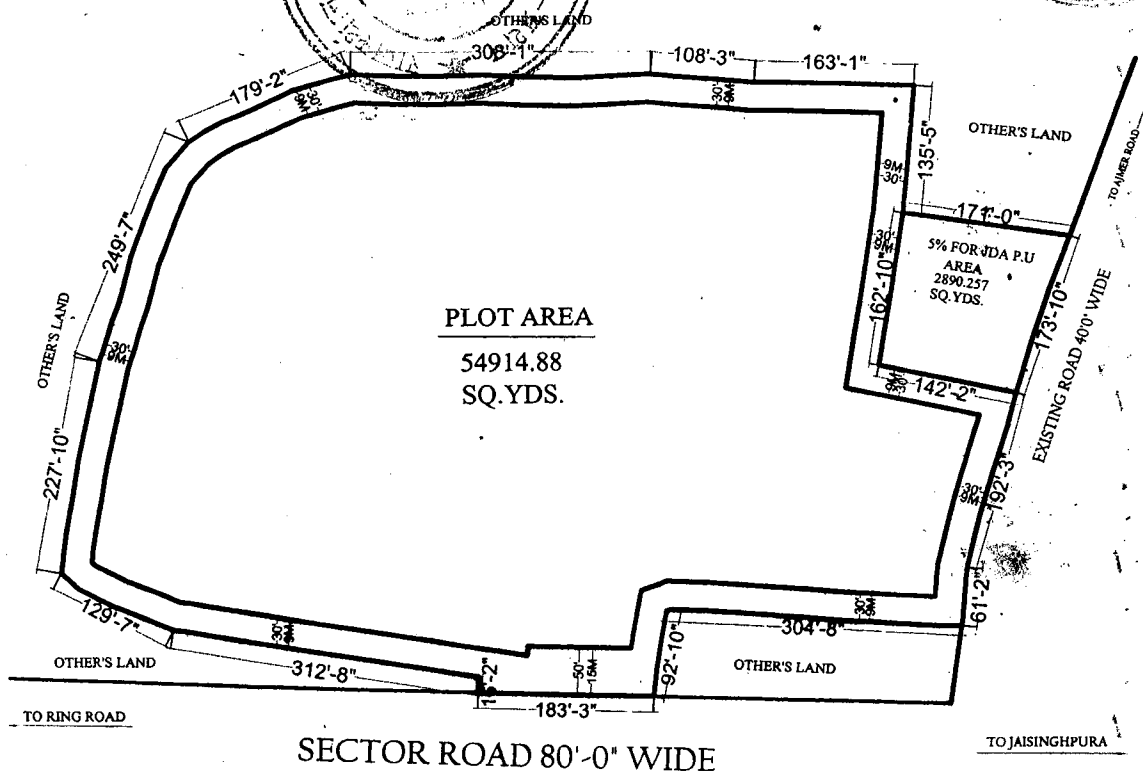

SITE ENGINEER  
ZONE-11

ATP/DTP  
ZONE-11

नपायुक्त जीन-11  
जयपुर विकास प्राधिकरण  
COMMISSIONER  
ZONE-11

JAIPUR DEVELOPMENT AUTHORITY, JAIPUR