

# ASHAPURNA VALLEY ORCHARD III AT JODHPUR KHASRA NO. 27/1

## RAIN WATER HARVESTING SUPPLY

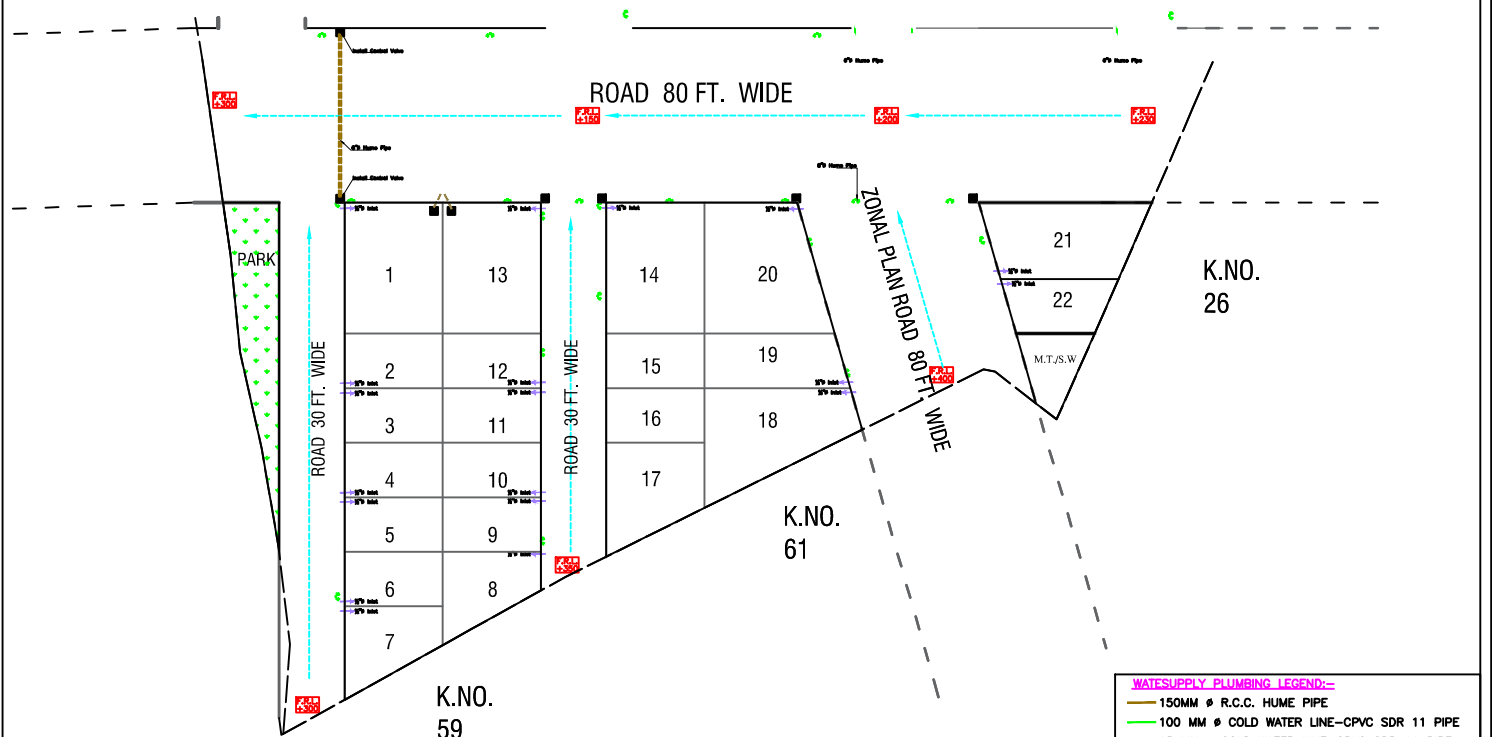
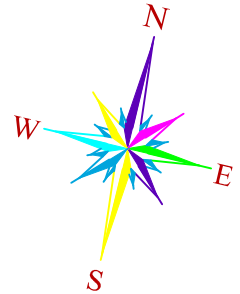

NOTE : THAT THIS PLAN IS ONLY TENTATIVE  
SOME CHANGES MIGHT HAPPEN AS PER SITE  
CONDITION

PROJECT : KHARA NO. 27/1	SIGN AND STAMP :  GAURAV JOSHI CIVIL ENGINEER 12, Near Maheshwari Nayati Nohra Masuriya, Jodhpur		<table><tr><td>REV.</td><td>NO.</td><td>DATE</td><td>DESCRIPTION</td></tr><tr><td>R2</td><td>13-05-24</td><td>APPROVAL</td><td></td></tr><tr><td>R1</td><td>26.02.24</td><td>APPROVAL</td><td></td></tr><tr><td>R0</td><td>29.01.24</td><td>PRELIMINARY</td><td></td></tr></table>	REV.	NO.	DATE	DESCRIPTION	R2	13-05-24	APPROVAL		R1	26.02.24	APPROVAL		R0	29.01.24	PRELIMINARY		DRG. TITLE : RAIN WATER HARVESTING SUPPLY KH 27/1	MEPF CONSULTANT <b>KARMA</b> MEPF CONSULTANTS B404, ARISE ICON, NEAR UMIYA CAMPUS, BEHIND- SG BUSINESS HUB, SG HIGHWAY, AHMEDABAD, GUJARAT, INDIA, M- 09727745689, Email Id : vivekpriya@karmamepf.com, vivekpriya4509@gmail.com	
				REV.	NO.	DATE	DESCRIPTION															
R2	13-05-24	APPROVAL																				
R1	26.02.24	APPROVAL																				
R0	29.01.24	PRELIMINARY																				
<table><tr><td>PREP. BY</td><td>NAME</td><td>SDN</td><td>DATE</td><td>SCALE</td><td colspan="2">SUBMITTED FOR</td></tr><tr><td>CHKD. BY</td><td>MANISH</td><td>13-05-24</td><td>NTS</td><td></td><td>PRELIMINARY</td><td>APPROVAL</td></tr><tr><td>APP. BY</td><td></td><td></td><td></td><td>DWG. NO.</td><td>MEP 02</td><td>REV. R1</td></tr></table>	PREP. BY	NAME	SDN	DATE	SCALE	SUBMITTED FOR		CHKD. BY	MANISH	13-05-24	NTS		PRELIMINARY	APPROVAL	APP. BY				DWG. NO.	MEP 02	REV. R1	
PREP. BY	NAME	SDN	DATE	SCALE	SUBMITTED FOR																	
CHKD. BY	MANISH	13-05-24	NTS		PRELIMINARY	APPROVAL																
APP. BY				DWG. NO.	MEP 02	REV. R1																