

# WATER SUPPLY

## LAYOUT PLAN

SCALE 1CM = 6M

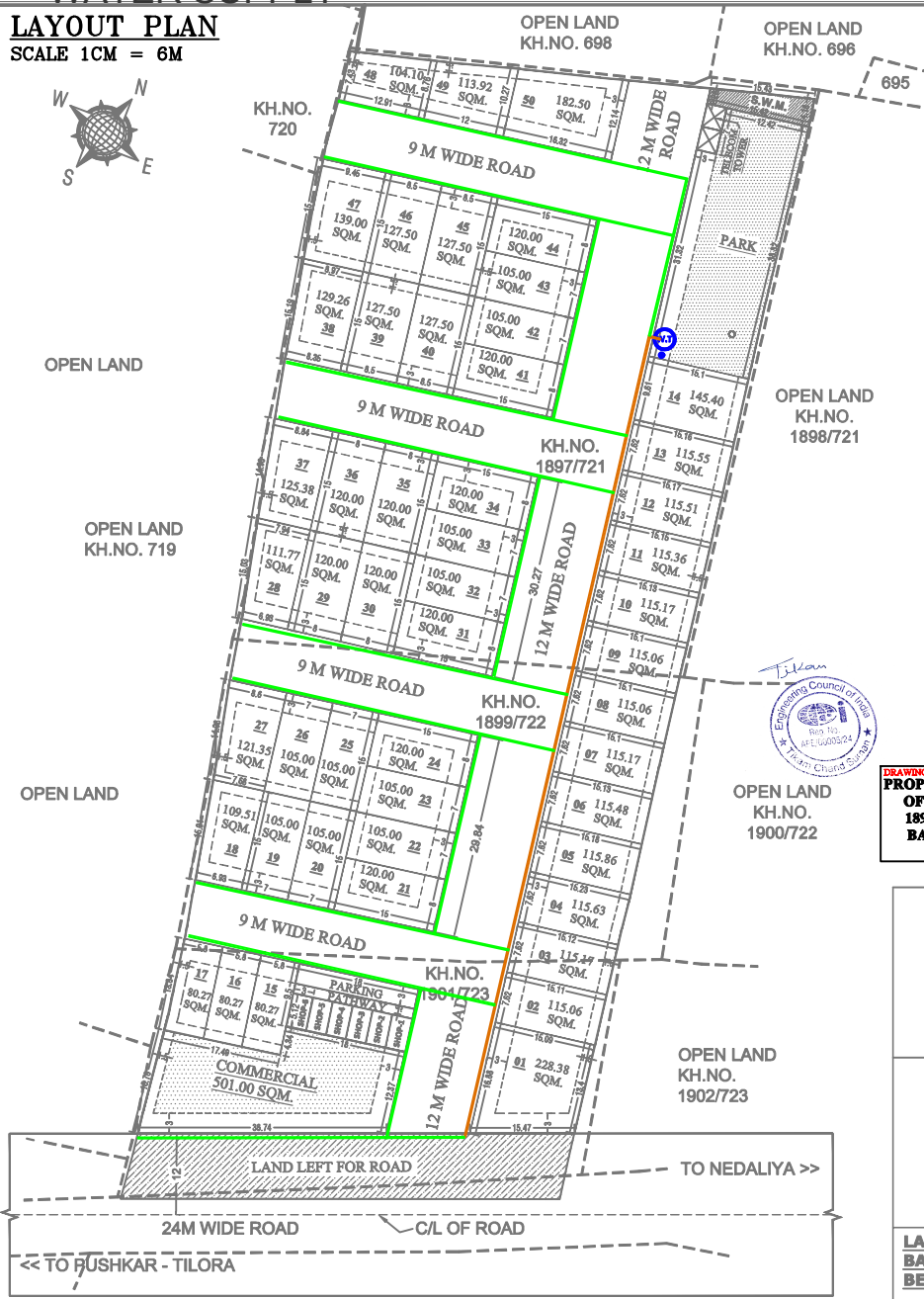

## VRINDAVAN VIHAR

SYMBOL	DESCRIPTION
<span style="color: red;">—</span>	160 mm PVC Water Pipe
<span style="color: green;">—</span>	110 mm PVC Water Pipe
<span style="color: blue;">→</span>	Slope Flow Direction
<span style="color: blue;">(W.T.)</span>	WATER TANK
<span style="color: blue;">○</span>	BORWELL/ BORING

PLOT NO.	AREA IN SQM.	PLOT NO.	AREA IN SQM.	PLOT NO.	AREA IN SQM.
1	228.38	18	109.51	35	120.00
2	115.06	19	105.00	36	120.00
3	115.17	20	105.00	37	125.38
4	115.63	21	120.00	38	129.26
5	115.86	22	105.00	39	127.50
6	115.48	23	105.00	40	127.50
7	115.17	24	120.00	41	120.00
8	115.06	25	105.00	42	105.00
9	115.06	26	105.00	43	105.00
10	115.17	27	121.35	44	120.00
11	115.36	28	111.77	45	127.50
12	115.51	29	120.00	46	127.50
13	115.55	30	120.00	47	139.00
14	145.40	31	120.00	48	104.10
15	80.27	32	105.00	49	113.92
16	80.27	33	105.00	50	182.50
17	80.27	34	120.00		
TOTAL PLOTS AREA = 5895.46 SQM.					

### NOTE:-

PROPOSED SITE SHOWN IN RED.  
KHASRA LINE SHOWN IN GREEN.  
SETBACK SHOWN IN BLUE.

TOTAL PLOT AREA	= 5895.46 SQM. = 52.64%
TOTAL AREA OF COMMERCIAL	= 501.00 SQM. = 04.47%
TOTAL AREA OF INFORMAL SHOPS	= 171.00 SQM. = 01.53%
TOTAL AREA OF PARK	= 560.55 SQM. = 05.00%
TOTAL ROAD AREA	= 3375.99 SQM. = 30.14%
LAND LEFT FOR ROAD	= 625.00 SQM. = 05.58%
TOTAL AREA OF S.W.M.	= 50.00 SQM. = 00.45%
TOTAL AREA OF TELECOM TOWER	= 21.00 SQM. = 00.19%
TOTAL LAND AREA	= 11200.00 SQM. = 100.00%

DRAWING  
PROPOSED WATER SUPPLY FOR LAYOUT PLAN  
OF VRINDAVAN VIHAR AT KHLNO. 1897/721,  
1899/722, 1901/723, SITUATED AT REV. VILL.  
BANSELI, TEH.-PUSHKAR, DISTT.-AJMER.

ARCHITECT	PATWARI	TEHSILDAR	DIR.PLANING
APPLICANT	JEN	A.T.P	DY.COMMISSIONER
LAYOUT PLAN SHOWING OF LAND KH.NO. 1897/721, 1899/722, 1901/723, SITUATED AT REV. VILL. BANSELI, TEH.-PUSHKAR, DISTT.-AJMER. BELONGS TO :- SH. JAGDEESH SINGH RATHORE S/O SH. NARAYAN SINGH.			