

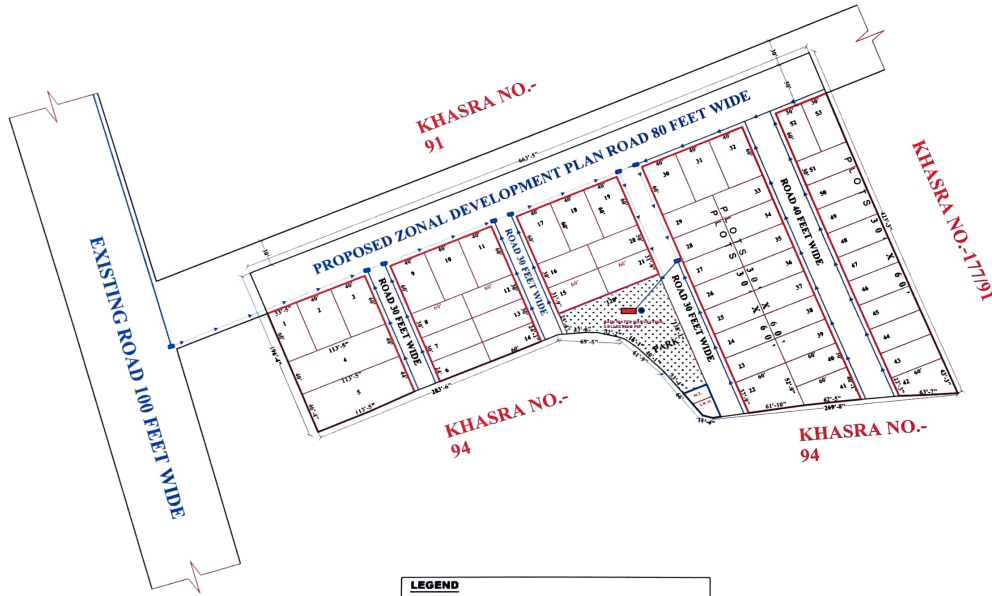



PROPOSED RAIN WATER HARVESTING NETWORK LAY OUT PLAN OF KHASRA NO.-91/5 , VILLAGE -BASNI BAGHELA, TEH-LUNI , DIST. -JODHPUR(RAJ.)



| LEGEND | | |
|---------------|--------------------------------|---|
| 1 | RAIN WATER LINE |  |
| 2 | RAIN WATER SAUCER DRAIN | 300 MM DIA |
| 4 | WATER CATCH BASIN | 800X900 MM |
| 5 | GREEN AREA |  |
| 6 | FOOTPATH AREA |  |

Notes:

- 1.0 This Drawing Shows The Network & Manholes of Each Zone.
- 2.0 All Units are in meters unless otherwise mentioned.
- 3.0 The following notation has been used for the representation of manholes
- 4.0 The manholes along the road are marked as: **M-0, M-1, M-2** Header pipe ID-manhole Number.
- 5.0 The manhole chambers in the individual plot are marked as: **I-1, I-2, I-3** Header pipe ID-individual Manholes number.
- 6.0 Refer the manhole level working sheet for individual manhole details
- 7.0 The sewer pipe shall be laid at a slope of 45-cm in 100.
- 8.0 This Drawing Shall be readable along with the sewer network plan drawing.
- 9.0 Any discrepancy in levels shall be brought to the notice of designer.

GAURAV JOSHI
Civil Engineer

12, Near Maheswari Nyati Nohra
Masuriya, Jodhpur

KEY-PLAN

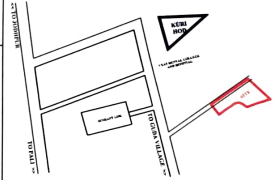

NOTE:-



SCALE :-1"=100'

PROPOSED WATER SUPPLY NETWORK LAY OUT PLAN OF KHASRA NO.-91/5, VILLAGE -BASNI BAGHELA, TEH-LUNI, DIST. -JODHPUR(RAJ.)

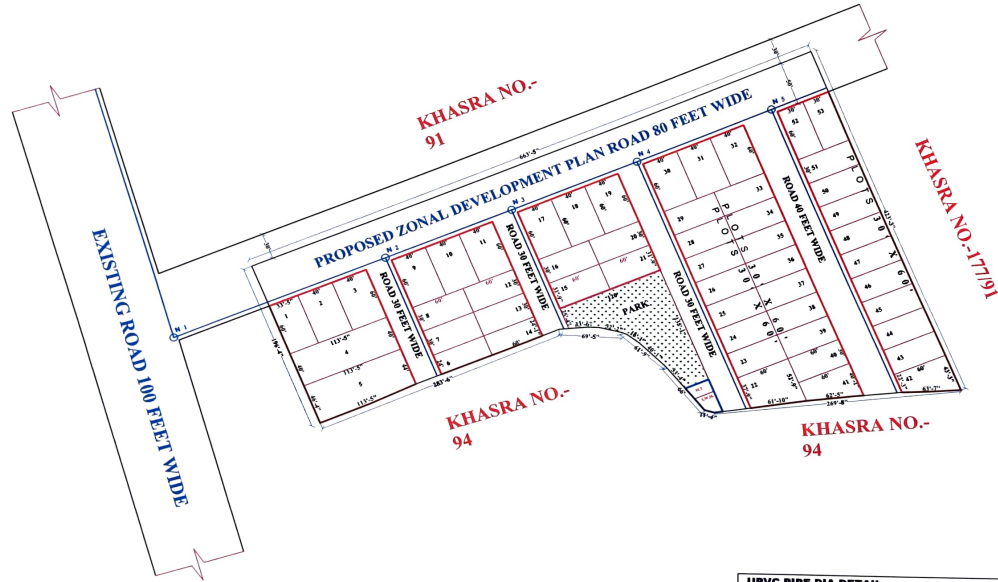

GAURAV JOSHI
Civil Engineer
Gaurav Joshi
12, Near Maheswari Nyati Nohra
Masuriya, Jodhpur

| UPVC PIPE DIA DETAIL | |
|----------------------|----------|
| COLOUR | DIAMETER |
| 1 | 75 MM |
| | |
| | |
| | |
| | |
| | |
| | |
| | |
| | |

KEY-PLAN

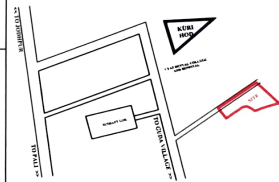

NOTE:-

