

PROPOSED SEWER NETWORK LAY OUT PLAN OF KHASRA NO.-91/5 , VILLAGE -BASNI BAGHELA, TEH-LUNI , DIST. -JODHPUR(RAJ.)

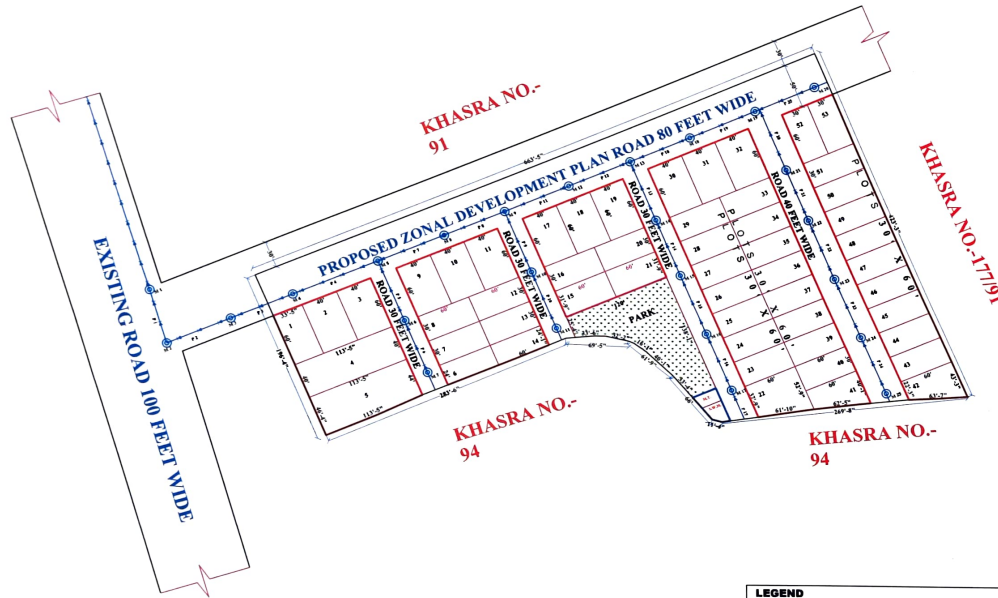

GAURAV JOSHI
Civil Engineer
[Signature]
12, Near Maheswari Nyati Nohra
Masuriya, Jodhpur

LEGEND	
1	SEWER LINE 200MM DIA WITH FLOW DIRECTION
2	MAN HOLE
3	PIPE NUMBER
4	DIA/LENGTH/SLOPE (MM) (M) (1 IN)
5	GROUND LEVEL
6	INVERT LEVEL

KEY-PLAN

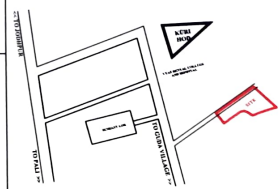

NOTE:-

