

SYMBOL	DESCRIPTION	SIZE	I.L. OF PIPES	NO. OF SLEEVES	LENGTH OF PIPE
A	INLET FROM TUBE WELL TO RAW WATER TANK	80Ø	+7'-0"	1	24"
B	MUNICIPAL WATER INLET TO RAW WATER TANK	50Ø	+7'-0"	1	24"
S	SUCTION PIPE FROM WATER TANK	80Ø	+7'-0"	1	24"
M	SLEEVE FOR LEVEL CONTROLLER(PVC CONDUIT)	25Ø	+7'-0"	1	24"
N	VENT PIPE (PVC SLEEVE)	50Ø	+7'-0"	1	24"

NOTE:- ALL INVERT LVL FROM WATER TANK UNFINISHED FLOOR LVL

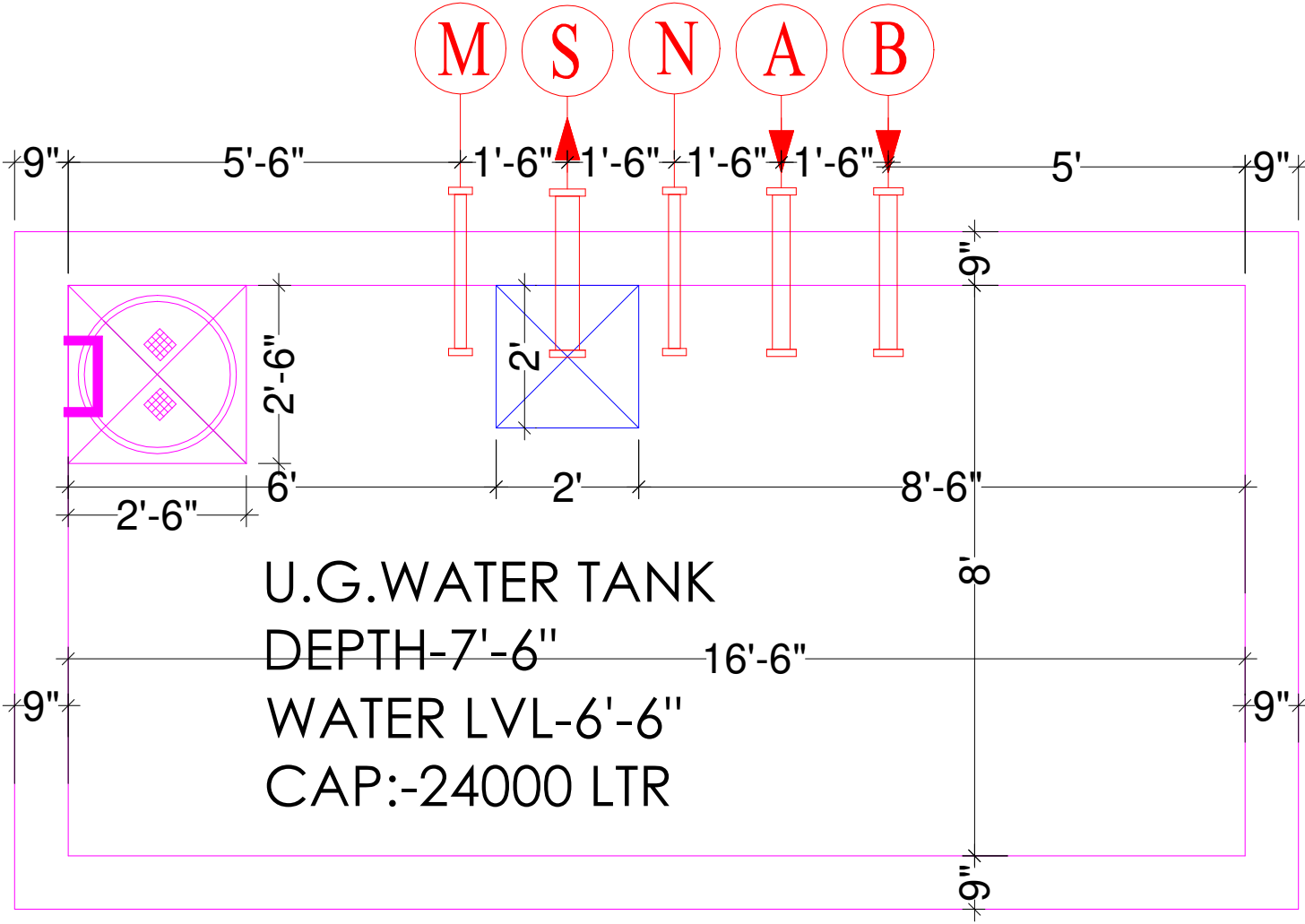
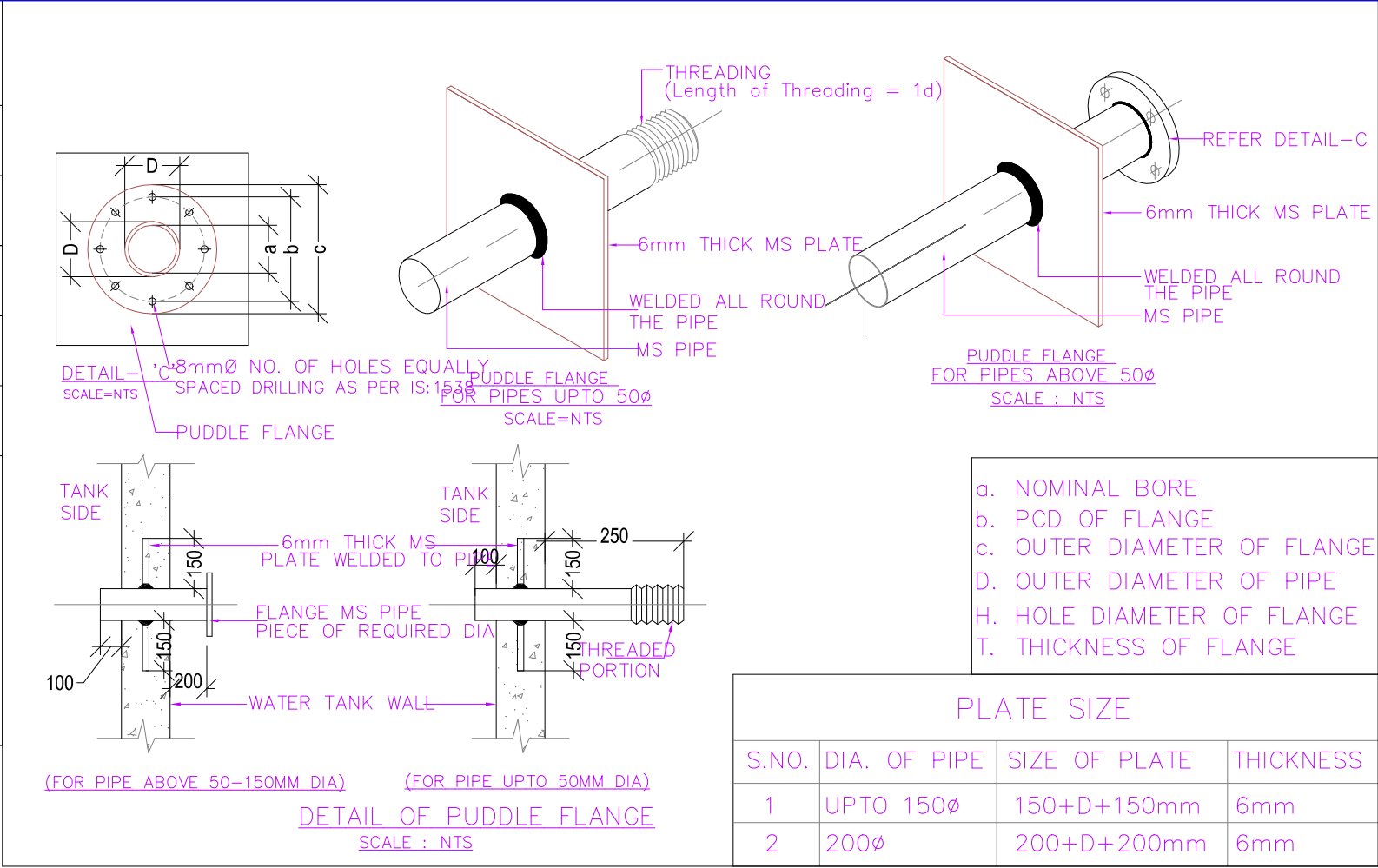

750Ø C.I M.H. COVER (DOUBLE SEAL WATER TIGHT AS PER APPROVED SPECIFICATION)

DRIVEWAY LVL
ROAD LVL

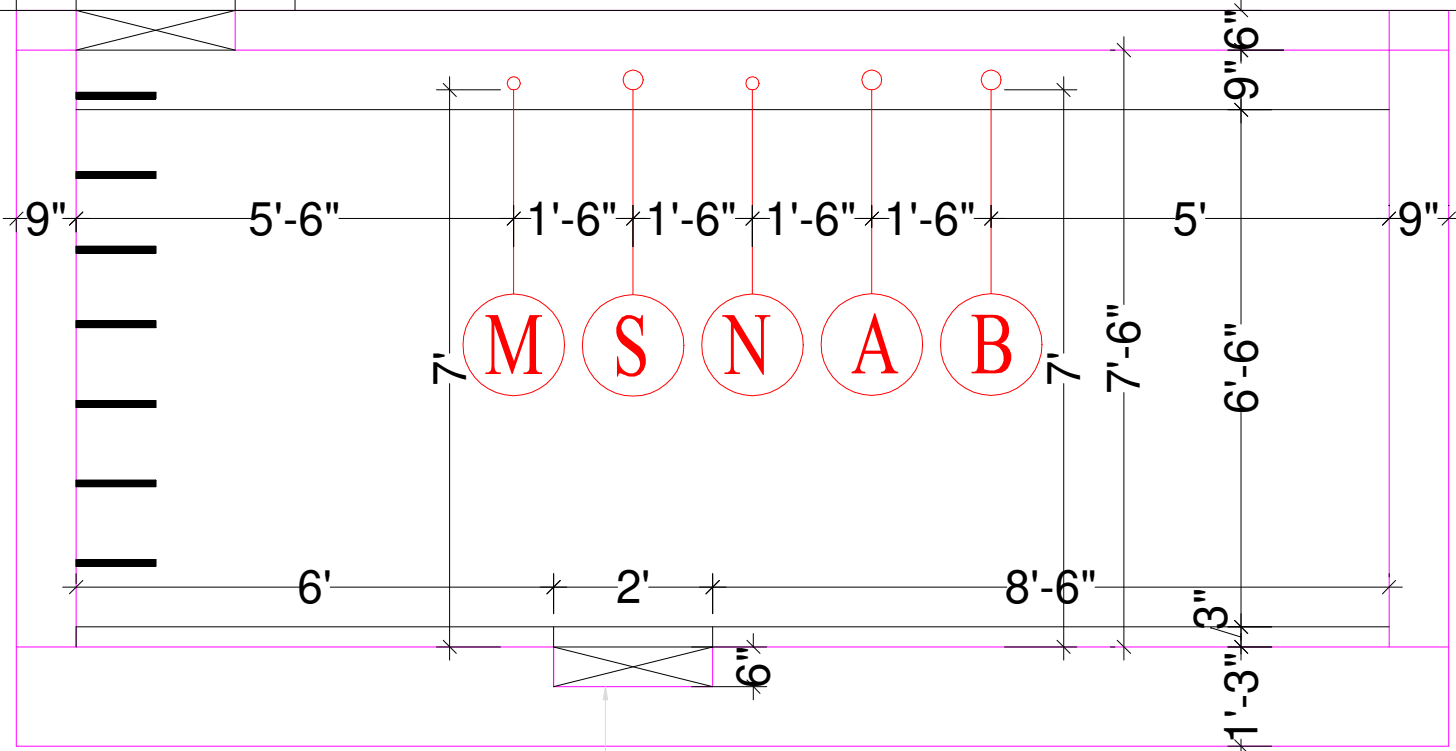

24"X24" X6" DEEP SUMP WITH INNER FINISHING IN WHITE GLAZED TILES

VIPUL AGARWAL
M.E.P. CONSULTANT
B.E. ELECTRICAL

PROJECT:- GURUKRIPA AARISE

PROJECT ADD.:- STUDIO APARTMENTS AT PLOT No.SB26 BAPUNAGAR , JAIPUR

STUDIO-1503
Architects, Interior Designers
Flat No:-G-101,PLOT-C1/44 SECTOR 1
Narayani Path,Chitrakoot , Jaipur
PH: +91-141-3571121
email : studio1503@gmail.com

THIS DRAWING IS THE PROPERTY OF STUDIO1503. IT SHALL NOT BE COPIED OR USED WITHOUT THEIR WRITTEN PERMISSION OR MADE KNOWN TO A THIRD PARTY. THE INFORMATION IS ISSUED ON THE UNDERSTANDING THAT NO PART THERE OF SHALL BE DUPLICATED FOR THE PURPOSE OTHER THAN THE EXPRESSED PURPOSE.

DATE:- 22-05-2025
DETAIL:- SANJAY
CHD:- SANJAY
APPD:- VIPUL AGARWAL

SERVICES CONSULTANT:
ASHI ASSOCIATES,
F 9 / 440 , Keshav Marg Chitrakut
Scheme,Jaipur
PH:91-0-93146-10438 /0141-2440946
Mail-vipul8599@yahoo.com

DRAWING:
UNDER GROUND WATER TANK
SECTION DETAILS PLAN

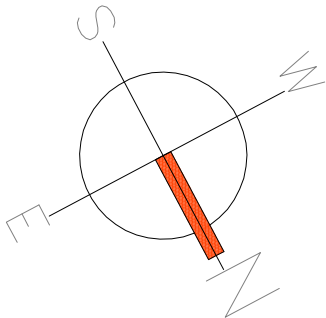

RAIN WATER HARVESTING TANK
SIZE-8'-0"X 8'-0"X 12'-6"
EFFECTIVE DEPTH
TOTAL DEPTH-14'-6"

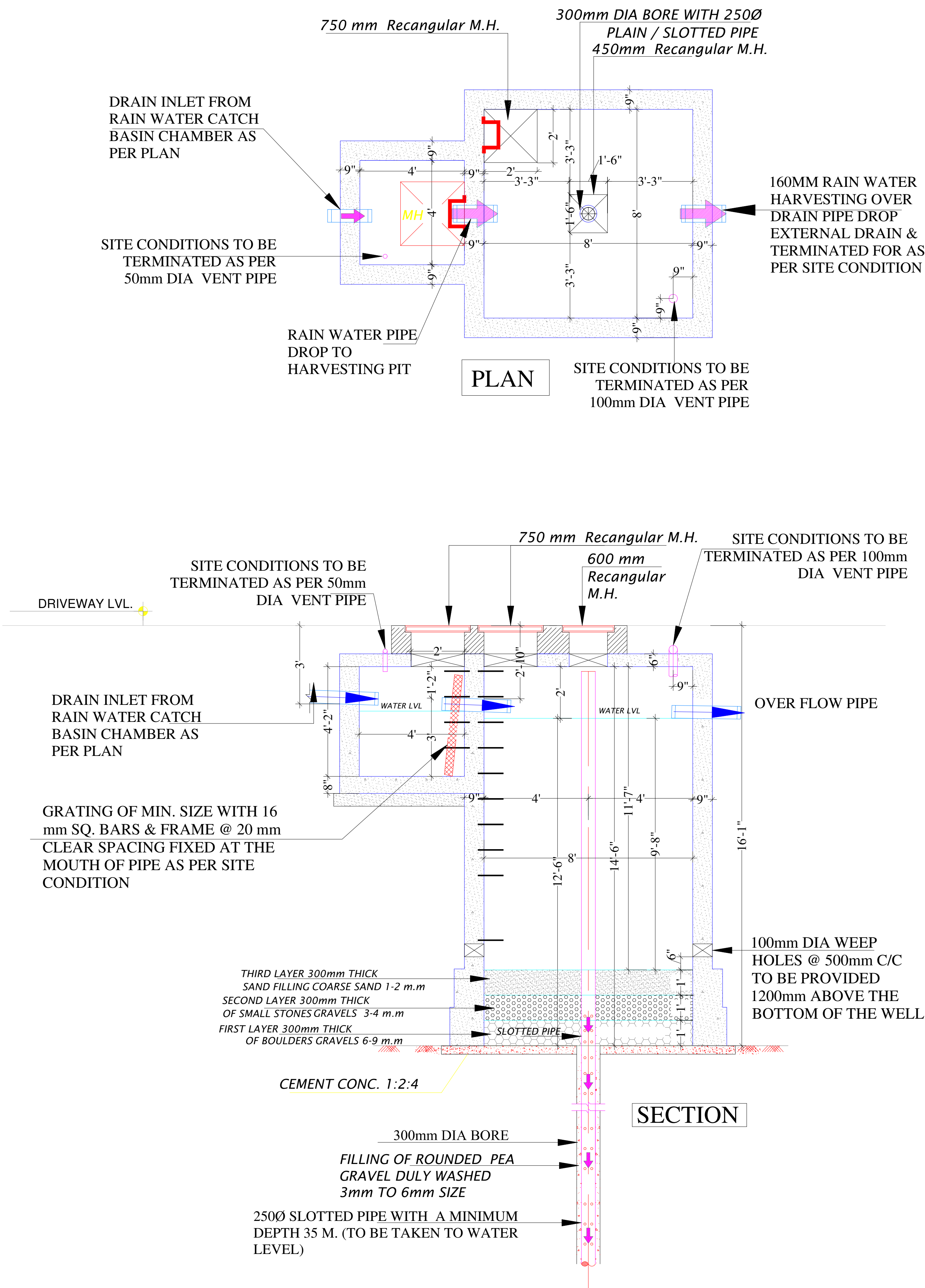

Vipul
VIPUL AGARWAL
M.E.P. CONSULTANT
B.E. ELECTRICAL

PROJECT:-
GURUKRIPA AARISE

PROJECT ADD.:-
STUDIO APARTMENTS AT PLOT
No.SB26 BAPUNAGAR , JAIPUR

STUDIO-1503
Architects, Interior Designers
Flat No:-G-101,PLOT-C1/44 SECTOR 1
Narayani Path,Chitrakoot , Jaipur
PH: +91-141-3571121
email : studio1503@gmail.com

THIS DRAWING IS THE PROPERTY OF STUDIO-1503. IT SHALL NOT BE COPIED
OR USED WITHOUT THEIR WRITTEN PERMISSION OR MADE KNOWN TO A THIRD PARTY. THE
INFORMATION IS ISSUED ON THE UNDERSTANDING THAT NO PART THERE OF SHALL BE
DUPLICATED FOR THE PURPOSE OTHER THAN THE EXPRESSED PURPOSE.

DATE:-
22-05-2025

DETAIL:-
SANJAY

CHD:-
SANJAY

APPD:-
VIPUL AGARWAL

SERVICES CONSULTANT:
ASHI ASSOCIATES,
F 9 / 440 , Keshav Marg Chitrakut
Scheme,Jaipur
PH:91-09146-10438,0141-2440946
Mail:vipul8599@yahoo.com

DRAWING:
RAIN WATER HARVESTING PIT
SECTION DETAILS PLAN

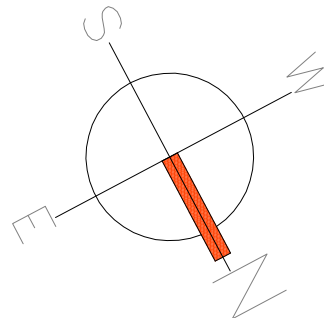

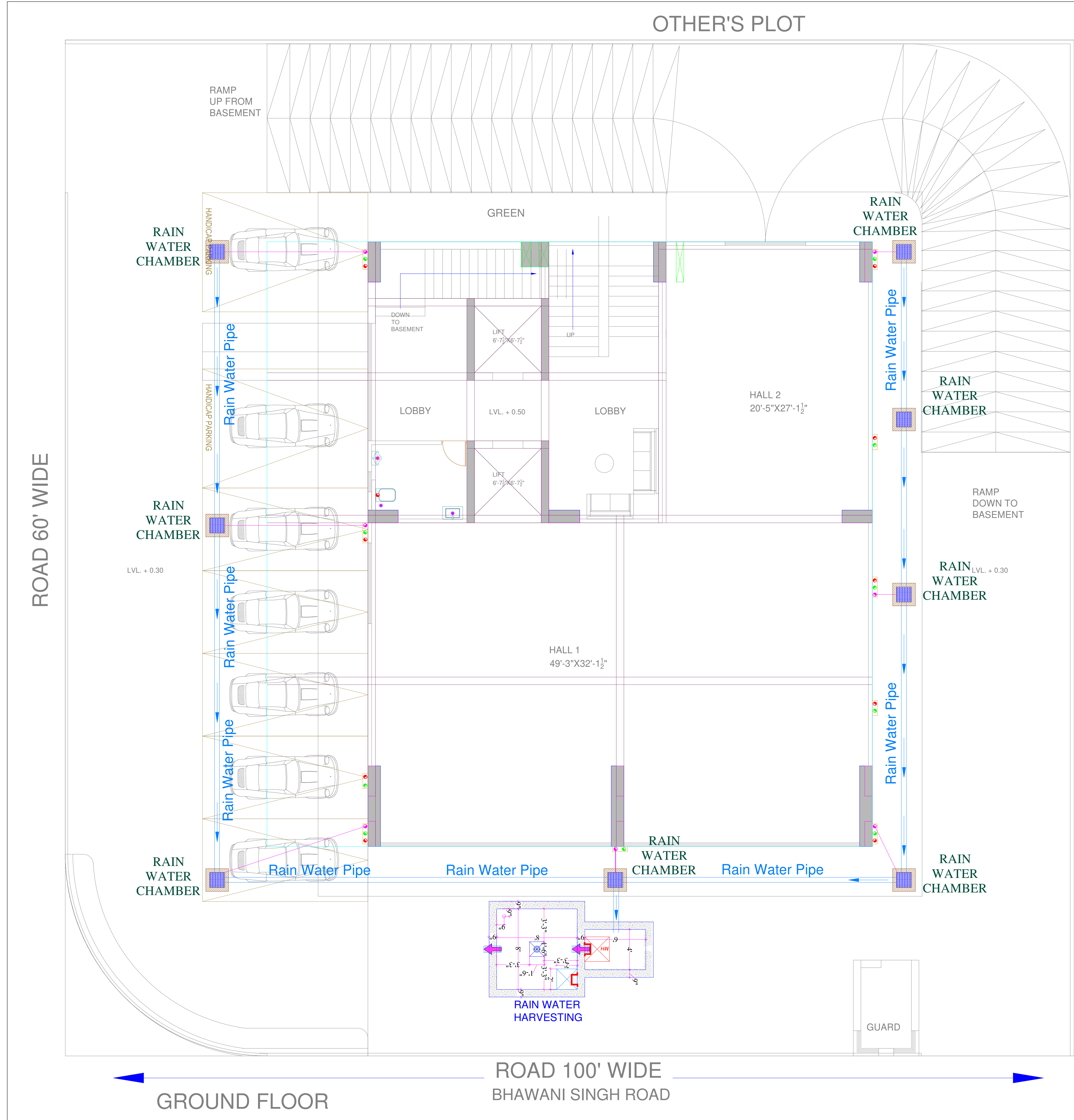

SYMBOL	DESCRIPTION
	Rain Water Pipe
	Rain Water Chamber
	Flow Direction

VIPUL AGARWAL
M.E.P. CONSULTANT
B.E. ELECTRICAL

MEP: –
SERVICES CONSULTANT:
ASHI ASSOCIATES
F 9 / 440 , Keshav Marg Chitrakut Scheme, Jaipur
PH: 91-0-93146-10438 , 0141-2440946
Mail: vipul8599@yahoo.com

PROJECT:-
GURUKRIPA AARISE

PROPOSED RESIDENTIAL STUDIO APARTMENTS PLOT SB 26 BAPUNAGAR SCHEME , JAIPUR

EXTERNAL RAIN WATER HARVESTING & PIPE ROUTE PLAN

DRAWN BY:- NITIN	
CHECKED BY:- SANJAY	
DATE : 21-05-2025	SCALE : N.T.S

studio1503
architectureinteriors
28032025
studio1503@gmail.com