



1. ALL DIMENSIONS ARE IN MM. AND INDICATIVE ONLY.  
SUITABLE AMENDMENTS MAY BE DONE AS PER ACTUAL SITE CONDITIONS.
2. THE DIMENSION OF STRUCTURAL ELEMENTS (FOUNDATION, WALL, SLAB ETC.) ARE ONLY INDICATIVE. THESE SHALL BE AS PER STRUCTURAL DRAWINGS.
3. THE DIMENSION 'X' SHALL BE CALCULATED ON THE BASIS OF INVERT OF UPSTREAM DRAIN

A-01

Er. SANJEEV SHARMA  
B.E ( Electrical )



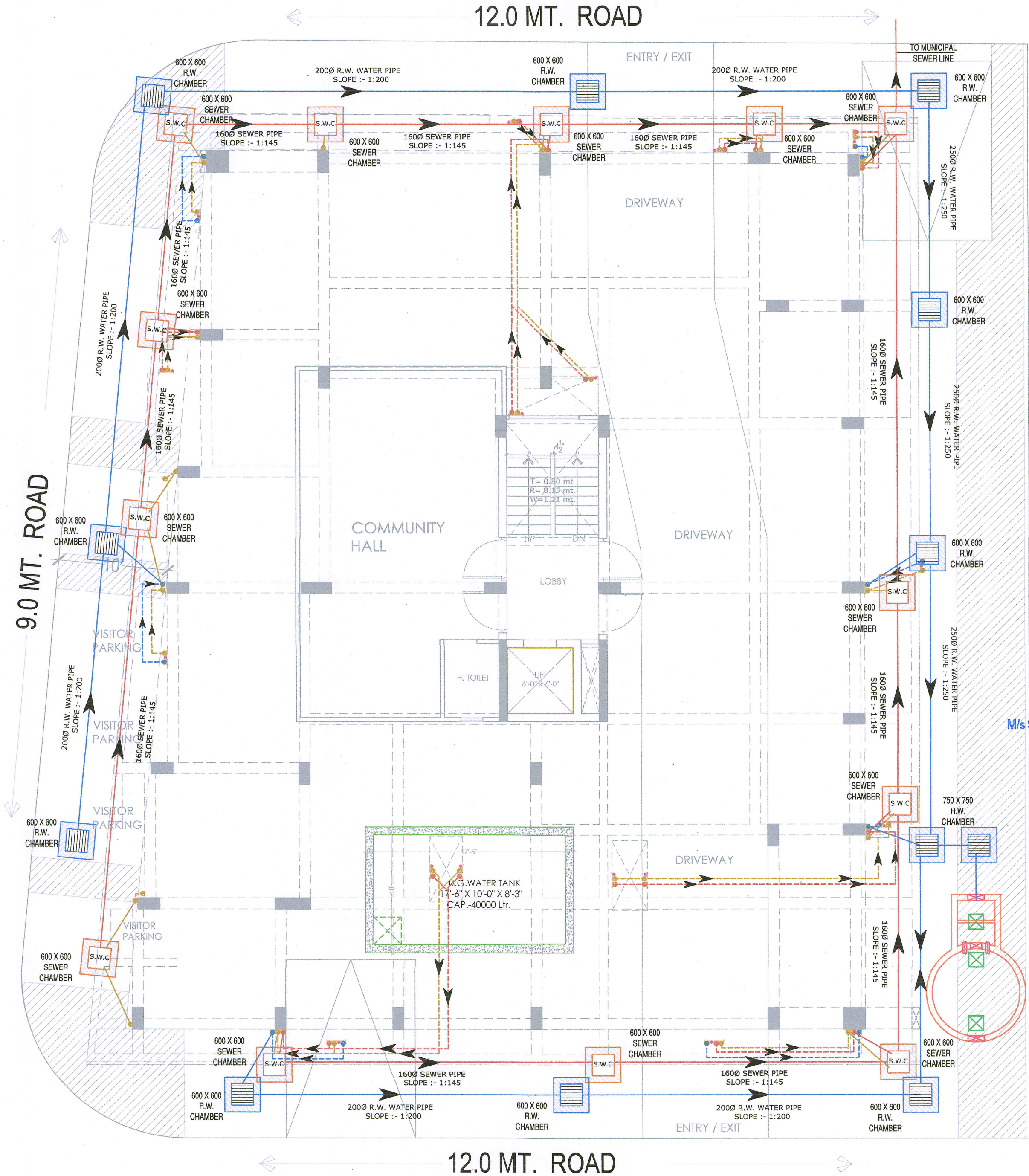

PROJECT NAME :  
CRYSTAL HEIGHTS  
DEVELOPER NAME :  
SIDDHI VINAYAK HOMES

LEGEND:-

①	SOIL PIPE	
②	WASTE PIPE	
③	VENT PIPE	
④	COLD WATER SUPPLY (CWS)	
⑤	HOT WATER SUPPLY (HWS)	
	RAIN WATER PIPE	
SW	SEWER LINE- EXTERNAL	
RW	STORM WATER DRAINAGE PIPE	
	SEWERAGE MANHOLE	M.H.
	STORM WATER MANHOLE	M.H.
GT	GULLY TRAP	
BV	BALL VALVE	
FT	FLOOR TRAP	
FD	FLOOR FLOOR DRAIN	
	RAIN WATER COLLECTION CHAMBER 450X450MM	
	KHURRA	

S.No	DATE	REVISION DESCRIPTION
GENERAL NOTES :		
1.	All dimension on this drawing are in MKS System. Only written dimensions are to be followed. drawing should not be scaled.	
2.	All measurements must be checked and verified by the contractors prior to execution of work at the site.	
3.	This drawing is to be read in conjunction with all relevant structural, services & facility planning drawings.	
4.	Architectural drawings are to be followed for the location of all structural members & masonry walls. for sizes & reinforcement details of structural members, relevant structural drawings are to be referred.	
5.	Any discrepancies between architectural, structural and services drawings must be brought to the notice of the architect immediately & prior to execution at site.	
6.	Co-ordination with services such as hvac, plumbing & electrical, etc. is the responsibility of the contractor.	
7.	All masonry walls should be aligned with the columns as indicated on the plan, irrespective of the position as calculated with the dimensioning.	
8.	For details, refer relevant large scale detail drgs. as indicated.	

PROJECT:  
PROPOSED RESIDENTIAL FLATS ON  
P. NO.- 115, 116, 117, 118, 119 & 120  
SCHEME- GANESH NAGAR -B,  
JAIPUR

NAME OF DRAWING:  
STILT FLOOR (WATER SUPPLY,  
RAINWATER HARVESTING,  
SANITATION & COMMON  
PLUMBING ) DRAWING

DRAWING WORKING DRAWING	NORTH: 
PROJECT NO. :	DATE : 15, May. - 2024
SCALE : NTS	REV NO. : R-0

DRAWING NO. :					
PROJECT	CATEGORY	BLOCK	FLOOR	TYPE	NUMBER
					A-01

STILT FLOOR (WATER SUPPLY, RAINWATER HARVESTING, SEWAGE  
SANITATION & COMMON PLUMBING ) DRAWING



PROJECT NAME :  
CRYSTAL HEIGHTS  
DEVELOPER NAME :  
SIDDHI VINAYAK HOMES

LEGEND:-

①	SOIL PIPE	
②	WASTE PIPE	
③	VENT PIPE	
④	COLD WATER SUPPLY (CWS)	
⑤	HOT WATER SUPPLY (HWS)	
	RAIN WATER PIPE	
SW	SEWER LINE- EXTERNAL	
RW	STORM WATER DRAINAGE PIPE	
	SEWERAGE MANHOLE	M.H.
	STORM WATER MANHOLE	M.H.
GT	GULLY TRAP	
BV	BALL VALVE	
FT	FLOOR TRAP	
FD	FLOOR FLOOR DRAIN	
	RAIN WATER COLLECTION CHAMBER 450X450MM	
	KHURRA	

S.No	DATE	REVISION DESCRIPTION
GENERAL NOTES :		
1.	All dimension on this drawing are in MKS System Only written dimensions are to be followed. drawing should not be scaled.	
2.	All measurements must be checked and verified by the contractors prior to execution of work at the site.	
3.	This drawing is to be read in conjunction with all relevant structural, services & facility planning drawings.	
4.	Architectural drawings are to be followed for the location of all structural members & masonry walls, for sizes & reinforcement details of structural members, relevant structural drawings are to be referred.	
5.	Any discrepancies between architectural, structural and services drawings must be brought to the notice of the architects immediately & prior to execution at site.	
6.	Co-ordination with services such as hvac, plumbing & electrical, etc. is the responsibility of the contractor.	
7.	All masonry walls should be aligned with the columns as indicated on the plan, irrespective of the position as calculated with the dimensioning.	
8.	For details, refer relevant large scale detail drgs. as indicated.	

PROJECT:  
PROPOSED RESIDENTIAL FLATS ON  
P. NO.- 115, 116, 117, 118, 119 & 120  
SCHEME- GANESH NAGAR -B,  
JAIPUR

NAME OF DRAWING:  
TERRACE FLOOR (WATER SUPPLY,  
RAINWATER, SANITATION &  
COMMON PLUMBING ) DRAWING

DRAWING WORKING DRAWING	NORTH: 
PROJECT NO. :	DATE : 15, May. - 2024
SCALE : NTS	REV NO. : R-0

DRAWING NO. :					
PROJECT	CATEGORY	BLOCK	FLOOR	TYPE	NUMBER
					A-01

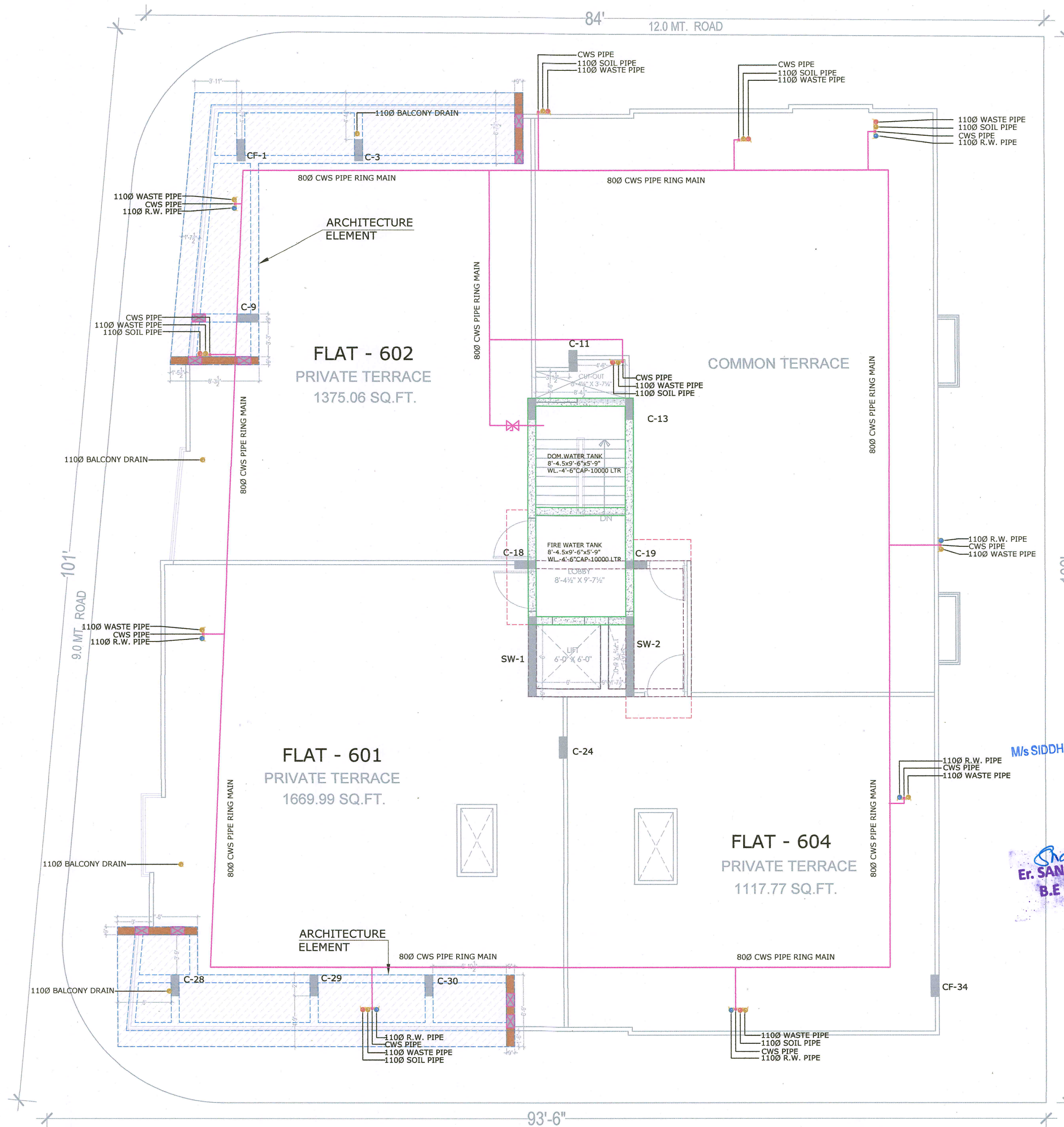

M/s SIDDHI VINAYAK HOMES  
NARENDRA  
PARTNER

Er. SANJEEV SHARMA  
B.E ( Electrical )

TERRACE FLOOR (WATER SUPPLY, RAINWATER,  
SANITATION & COMMON PLUMBING ) DRAWING