

OTHERS LAND

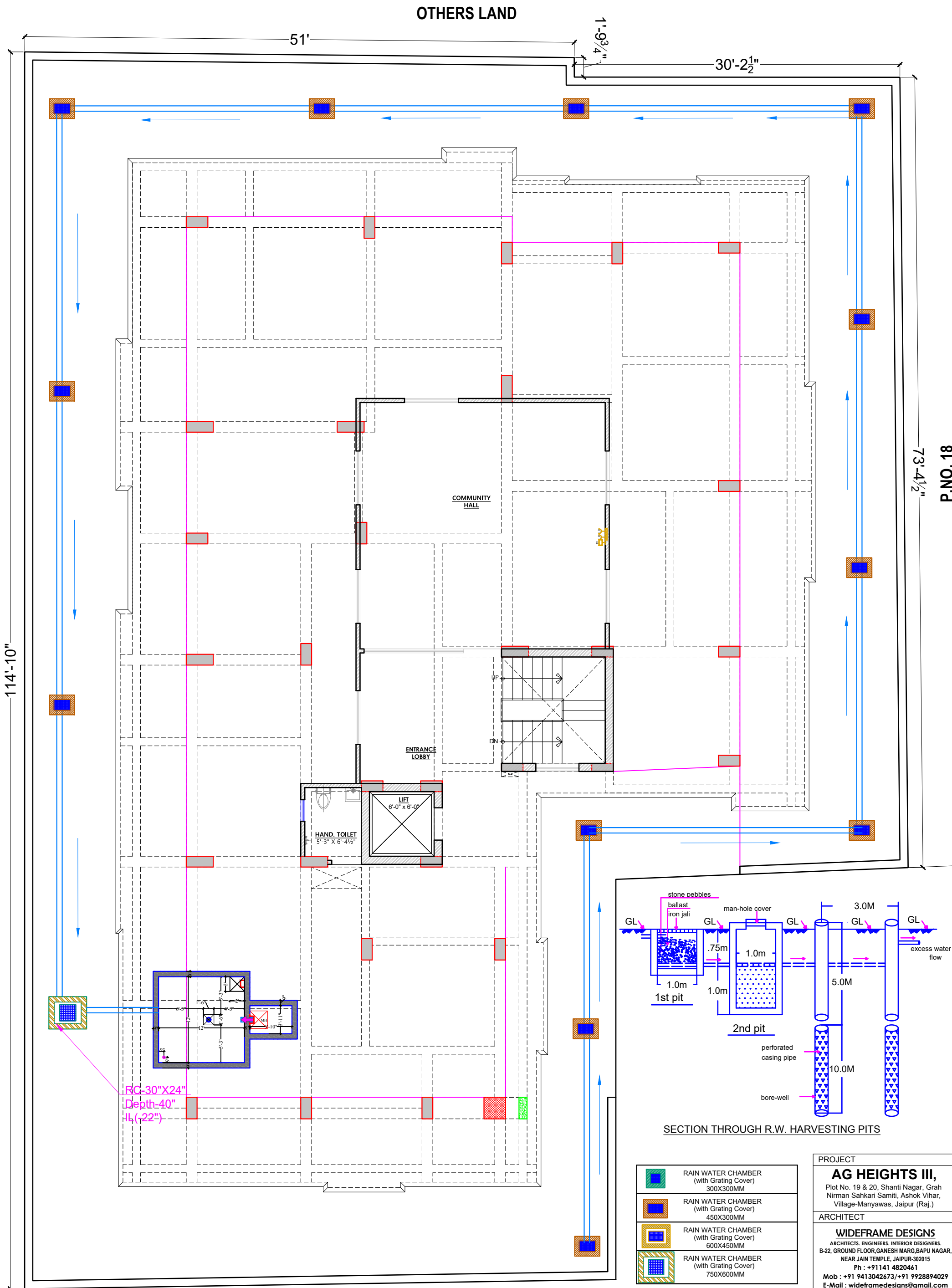

P.NO. 21

STILT FLOOR PLAN RAIN WATER HARVESTING LAYOUT

NAMAN YADAV
Naman Yadav
B.Tech (Service Consultant)

AARADHYA GOVIND DEVELOPERS
PARTNER

PROJECT
AG HEIGHTS III,
Plot No. 19 & 20, Shanti Nagar, Grah
Nirman Sahkari Samiti, Ashok Vihar,
Village-Manyawas, Jaipur (Raj.)
ARCHITECT
WIDEFRAME DESIGNS
ARCHITECTS, ENGINEERS, INTERIOR DESIGNERS.
B-22, GROUND FLOOR, GANESH MARG, BAPU NAGAR,
NEAR JAIN TEMPLE, JAIPUR-302015
Ph : +91141 4820461
Mob : +91 9413042673/+91 9928894029
E-Mail : wideframedesigns@gmail.com

RAIN WATER HARVESTING LAYOUT

WORKING DRAWING
SH.NO. DATE : 30-04-2024
02 SCALE:

NOTE
THIS DRAWING IS THE SOLE PROPERTY OF
WIDEFRAME DESIGNS AND IS NOT TO BE
COPIED, USED OR REPRODUCED FOR ANY
PURPOSE OTHER THAN FOR WHICH IT HAS BEEN
LOANED.
FILE PATH

SPDS/2024/11

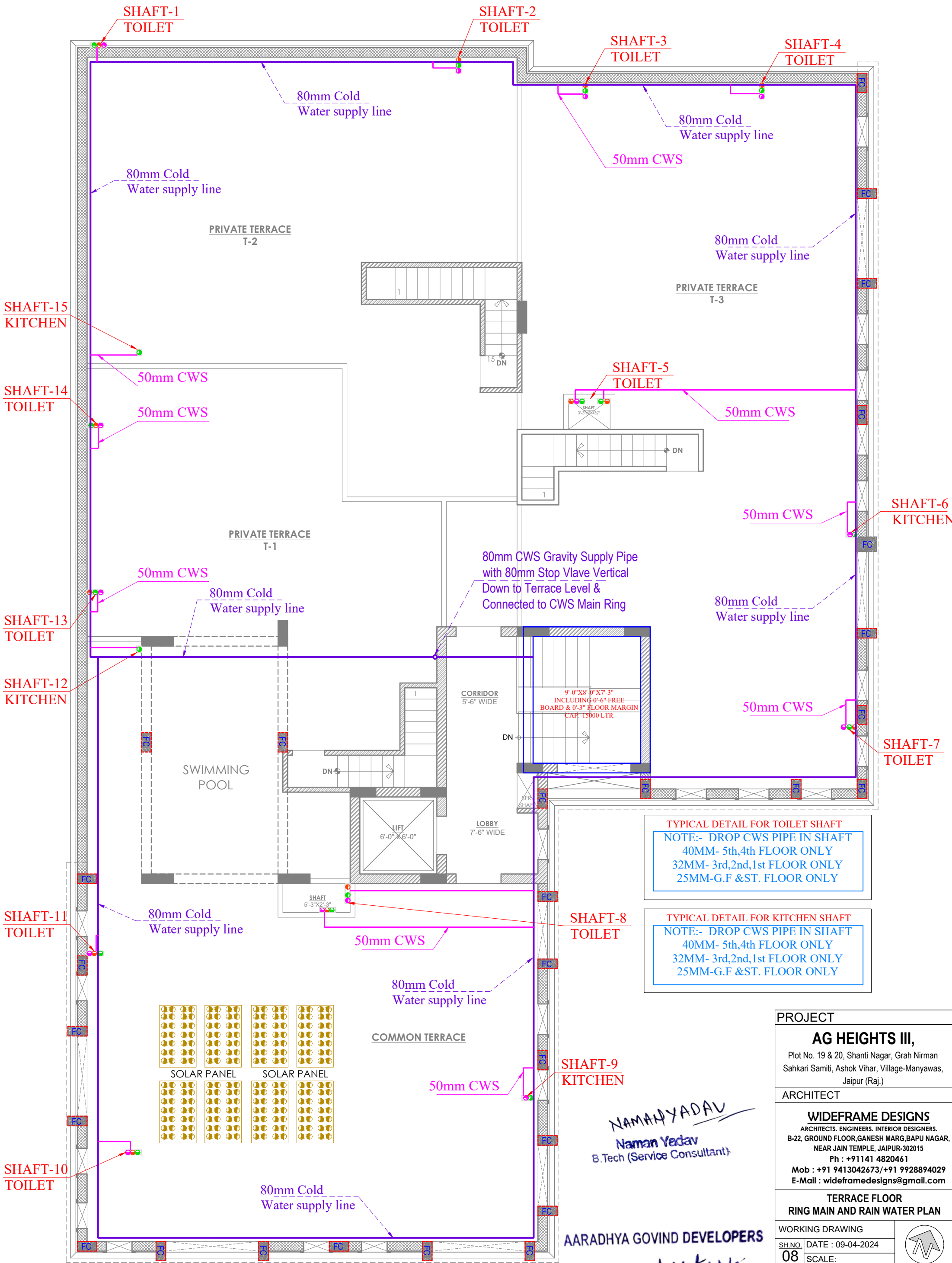

TERRACE FLOOR
RING MAIN AND RAIN WATER PLAN

TYPICAL DETAIL FOR TOILET SHAFT
NOTE:- DROP CWS PIPE IN SHAFT
40MM- 5th,4th FLOOR ONLY
32MM- 3rd,2nd,1st FLOOR ONLY
25MM-G.F &ST. FLOOR ONLY

TYPICAL DETAIL FOR KITCHEN SHAFT
NOTE:- DROP CWS PIPE IN SHAFT
40MM- 5th,4th FLOOR ONLY
32MM- 3rd,2nd,1st FLOOR ONLY
25MM-G.F &ST. FLOOR ONLY

PROJECT	
AG HEIGHTS III, Plot No. 19 & 20, Shanti Nagar, Grah Nirman Sahkari Samiti, Ashok Vihar, Village-Manyawas, Jaipur (Raj.)	
ARCHITECT	
WIDEFRAME DESIGNS ARCHITECTS. ENGINEERS. INTERIOR DESIGNERS. B-22, GROUND FLOOR, GANESH MARG, BAPU NAGAR, NEAR JAIN TEMPLE, JAIPUR-302015 Ph : +91141 4820461 Mob : +91 9413042673/+91 9928894029 E-Mail : wideframedesigns@gmail.com	
TERRACE FLOOR RING MAIN AND RAIN WATER PLAN	
WORKING DRAWING	08
SH.NO. DATE : 09-04-2024	
SCALE:	NOTE
THIS DRAWING IS THE SOLE PROPERTY OF SURYA PRAKASH DESIGN STUDIO AND IS NOT TO BE COPIED, USED OR REPRODUCED FOR ANY PURPOSE OTHER THAN FOR WHICH IT HAS BEEN LOANED.	
FILE PATH	SPDS/2024/11

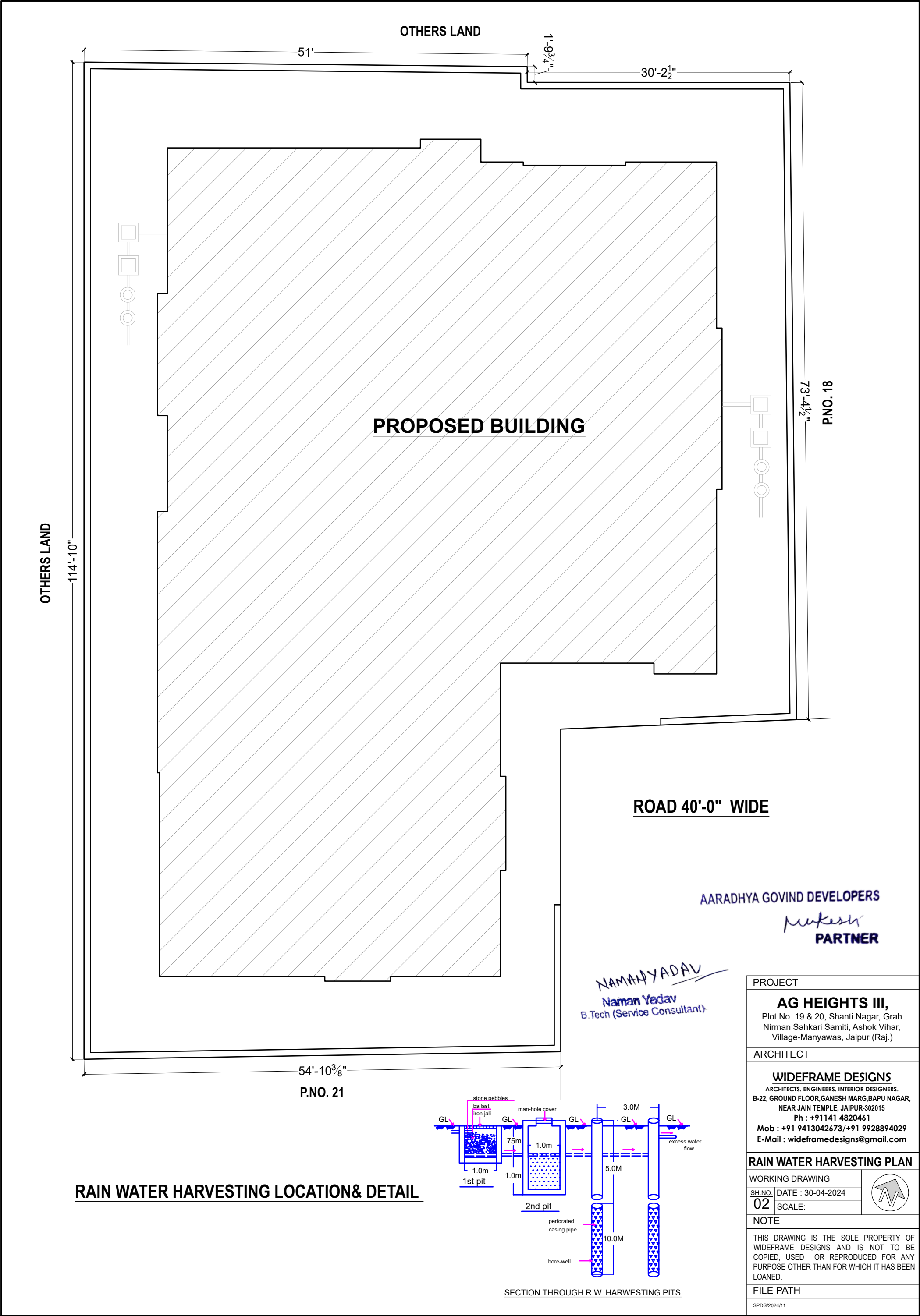

RAIN WATER HARVESTING LOCATION& DETAIL

AARADHYA GOVIND DEVELOPERS
PARTNER

NAMAN YADAV
Naman Yadav
B.Tech (Service Consultant)

PROJECT	
AG HEIGHTS III, Plot No. 19 & 20, Shanti Nagar, Grah Nirman Sahkari Samiti, Ashok Vihar, Village-Manyawas, Jaipur (Raj.)	
ARCHITECT	
WIDEFRADE DESIGNS ARCHITECTS. ENGINEERS. INTERIOR DESIGNERS. B-22, GROUND FLOOR, GANESH MARG, BAPU NAGAR, NEAR JAIN TEMPLE, JAIPUR-302015 Ph : +91141 4820461 Mob : +91 9413042673/+91 9928894029 E-Mail : wideframedesigns@gmail.com	
RAIN WATER HARVESTING PLAN	
WORKING DRAWING	
SH.NO. 02	
DATE : 30-04-2024	SCALE:
NOTE	
THIS DRAWING IS THE SOLE PROPERTY OF WIDEFRADE DESIGNS AND IS NOT TO BE COPIED, USED OR REPRODUCED FOR ANY PURPOSE OTHER THAN FOR WHICH IT HAS BEEN LOANED.	
FILE PATH	
SPDS/2024/11	

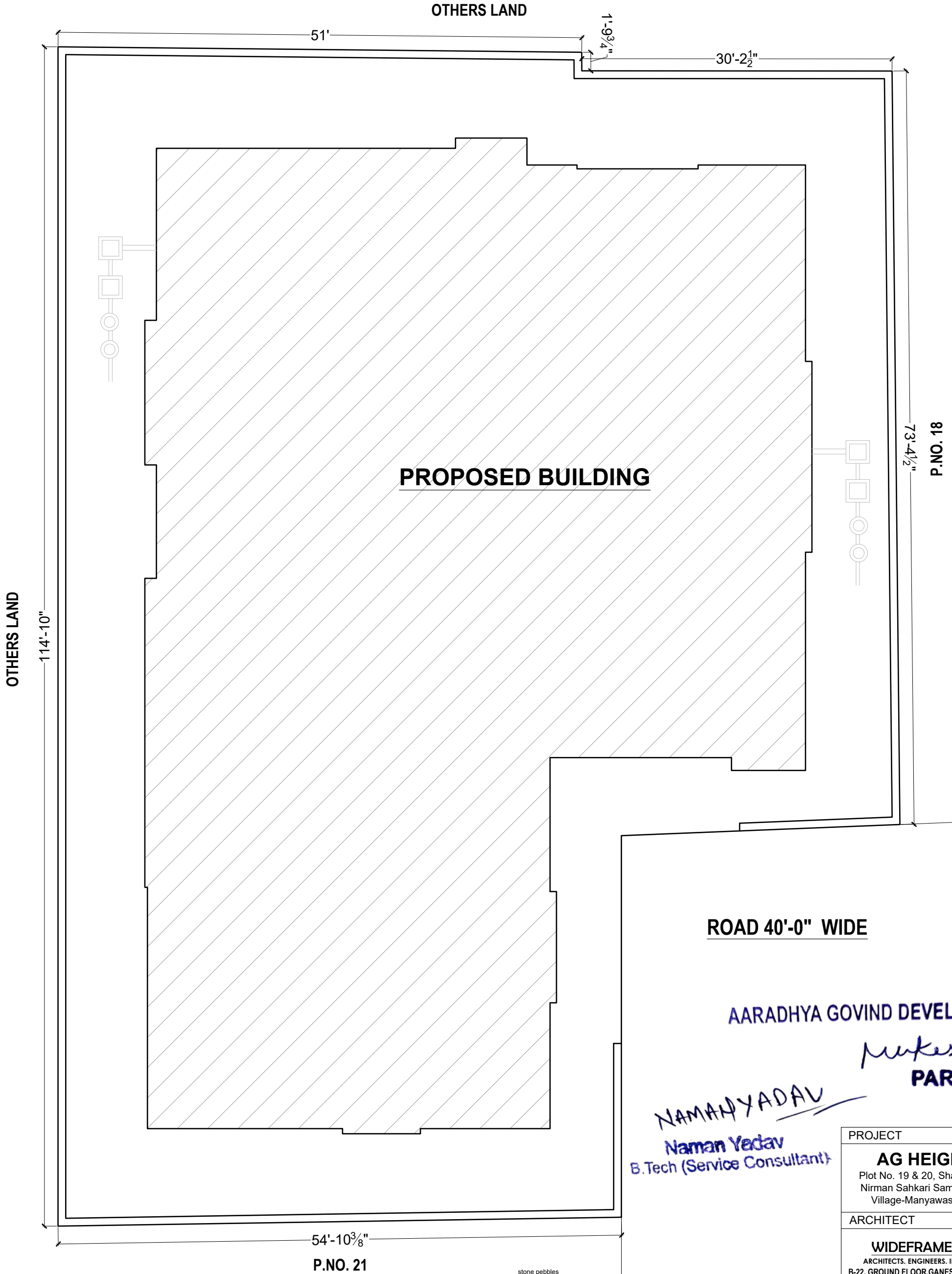

**STILT FLOOR
RAIN WATER HARVESTING LOCATION& DETAIL**

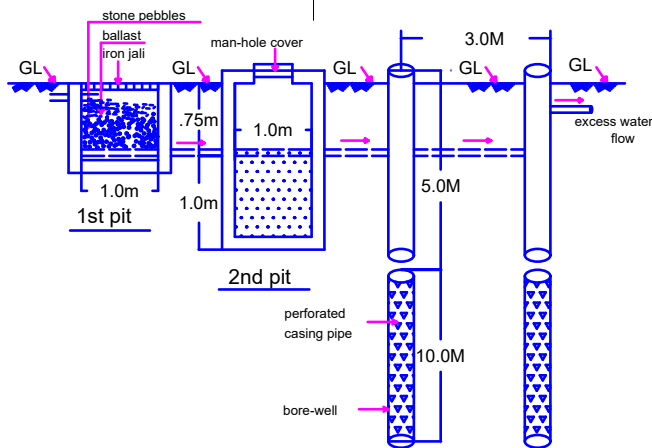

SECTION THROUGH R.W. HARVESTING PITS

PROJECT	
AG HEIGHTS III, Plot No. 19 & 20, Shanti Nagar, Grah Nirman Sahkari Samiti, Ashok Vihar, Village-Manyawas, Jaipur (Raj.)	
ARCHITECT	
WIDEFRAME DESIGNS ARCHITECTS. ENGINEERS. INTERIOR DESIGNERS. B-22, GROUND FLOOR, GANESH MARG, BAPU NAGAR, NEAR JAIN TEMPLE, JAIPUR-302015 Ph : +91141 4820461 Mob : +91 9413042673/+91 9928894029 E-Mail : wideframedesigns@gmail.com	
RAIN WATER HARVESTING PLAN	
WORKING DRAWING	
SH.NO. 02	
DATE : 30-04-2024	SCALE:
NOTE	
THIS DRAWING IS THE SOLE PROPERTY OF WIDEFRAME DESIGNS AND IS NOT TO BE COPIED, USED OR REPRODUCED FOR ANY PURPOSE OTHER THAN FOR WHICH IT HAS BEEN LOANED.	
FILE PATH	
SPDS/2024/11	